

# Model 3P30

## Current Transformer Window Diameter 2.88"

### Application

3 phase metering and other switchboard applications.

### Frequency

50-400 Hz.

### Insulation level

600 Volts, 10 kV BIL full wave.

Terminals are brass studs No. 8-32 with one flatwasher, lockwasher and regular nut.

Approximate weight 3 lbs.

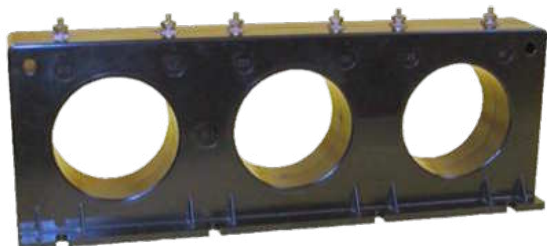

#### REGULATORY AGENCY APPROVALS



Manufactured to meet the requirements of ANSI/IEEE C57.13. Classified by U.L. in accordance with IEC 44-1

### Data Table Model 3P30

Catalog Number	Current Ratio	V.A. ± 1% Class	ANSI Metering Class at 60 Hz					Secondary Winding Resistance (Ohms @ 75°C)
			B0.1	B0.2	B0.5	B0.9	B1.8	
3P30-201	200:5	5	1.2	1.2	4.8	—	—	0.035
3P30-251	250:5	5	0.6	1.2	2.4	—	—	0.053
3P30-301	300:5	6	0.6	0.6	2.4	—	—	0.061
3P30-401	400:5	10	0.6	0.6	1.2	2.4	—	0.076
3P30-501	500:5	10	0.6	0.6	0.6	1.2	—	0.101
3P30-601	600:5	10	0.3	0.6	1.2	12	—	0.182
3P30-751	750:5	10	0.3	0.6	0.6	1.2	—	0.182
3P30-801	800:5	12.5	0.3	0.3	0.6	1.2	1.2	0.242
3P30-102	1,000:5	12.5	0.3	0.6	1.2	—	—	0.280
3P30-122	1,200:5	12.5	0.3	0.3	0.6	—	—	0.336
3P30-152	1,500:5	12.5	0.3	0.3	0.6	0.6	—	0.419
3P30-162	1,600:5	20	0.3	0.3	0.3	0.6	—	0.447
3P30-202	2,000:5	20	0.3	0.3	0.3	0.3	—	0.704

Notes: Holes at the top of the transformer case can be used for attaching auxiliary device mounting plate, (not supplied)  
If the application requires transformer mounted relays, etc., then transformer can be ordered with secondary leads configured in various ways (consult factory).



# Model 3P30

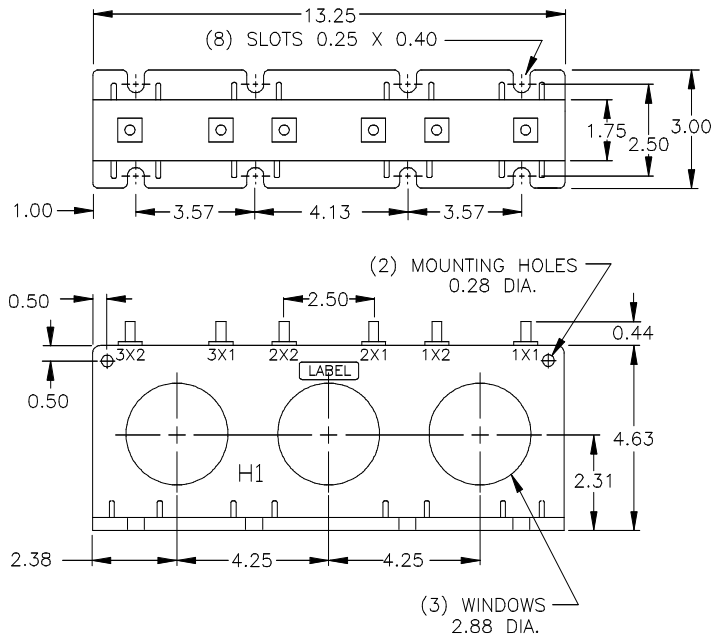
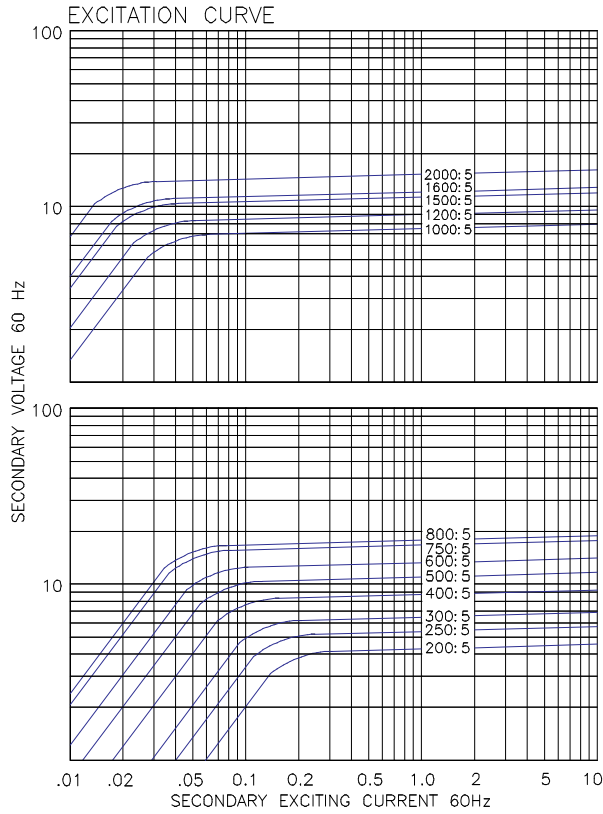

Grid-AIS-L4-ITL\_Model\_3P30-1190-2017\_04-EN. © Copyright 2017. General Electric Company and Instrument Transformers LLC reserve the right to change specifications of described products at any time without notice and without obligation to notify any person of such changes.

